

# SINGLE ACTING, SCREWED RAM, SPRING RETURN JACKS

**SMHYDRA**  
HYDRAULIC SOLUTIONS

**J-11**  
Pg 1/1

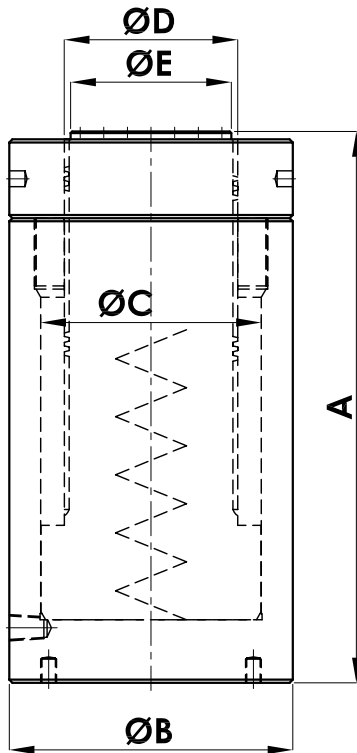

Suitable Hand Pump			
Tonnage	Model	Operating Stage	Oil Discharge
Upto 30T Jacks	HP-12	One	2.8 cc/stroke
Above 30T Jacks	HP-5012	1 <sup>st</sup> - upto 30 kg/cm <sup>2</sup>	49 cc/stroke
		2 <sup>nd</sup> - above 30 kg/cm <sup>2</sup>	2.8 cc/stroke

**Features:**

- \* 700 kg/cm<sup>2</sup> Series
- \* Multipurpose Industrial Application Jack
- \* Central-Load Application
- \* Base Hole Mounting & Collar Thread Mounting available on request
- \* Chrome Plated Body
- \* Motorised pumping units are also available

7SR Series    ⑦ 700 kg/cm<sup>2</sup>    ③ Single Acting Spring Return    ④ Screwed Ram    ⑤ Capacity (Ton)    ⑤① Lift (mm)  
③① Single Acting Load Return

Cylinder Capacity (tonnes)	Lift (mm)	Model/ Code	Effective Area (cm <sup>2</sup> )	Oil Capacity (cc)	Closed Height (mm) 'A'	Cylinder OD (mm) 'B'	Bore Dia. (mm) 'C'	Ram Dia. (mm) 'D'	Saddle Dia. (mm) 'E'	Weight (Approx.) 'kg'
10	150	7SR-10-150	15.9	238.6	250	62	45	40	33	4.8
15	150	7SR-15-150	23.8	356.4	262	70	55	45	42	6
20	150	7SR-20-150	28.3	424.1	275	85	60	52	47	9
25	150	7SR-25-150	38.5	577.3	280	95	70	56	50	12
30	150	7SR-30-150	44.2	662.7	295	100	75	60	54	15
40	150	7SR-40-150	63.6	954.3	305	120	90	75	53	25
50	150	7SR-50-150	78.5	1178.1	315	135	100	80	73	30
75	150	7SR-75-150	113.1	1696.5	325	160	120	90	87	42
100	150	7SR-100-150	153.9	2309.1	350	180	140	110	102	57
150	150	7SR-150-150	227	3404.7	365	225	170	140	132	105
200	150	7SR-200-150	314.2	4712.4	380	265	200	160	152	135
250	150	7SLR-250-150	380.1	5702	400	290	220	180	168	175
300	150	7SLR-300-150	452.4	6785.8	415	315	240	200	188	230
400	150	7SLR-400-150	572.6	8588.3	450	355	270	225	213	315
500	150	7SLR-500-150	706.9	10602.9	480	415	300	250	238	450
600	150	7SLR-600-150	855.3	12829.5	495	435	330	275	260	496
800	150	7SLR-800-150	1134.1	17011.7	535	508	380	310	290	735
1000	150	7SLR-1000-150	1418.6	21279.4	575	564	425	350	330	975

**Note: Customized Jacks are available on request. The dimension are subjected to change on account of design improvement.**